

REVISION HISTORY				
ZONE	REV	DESCRIPTION	DATE	APPROVED
	0			S.V

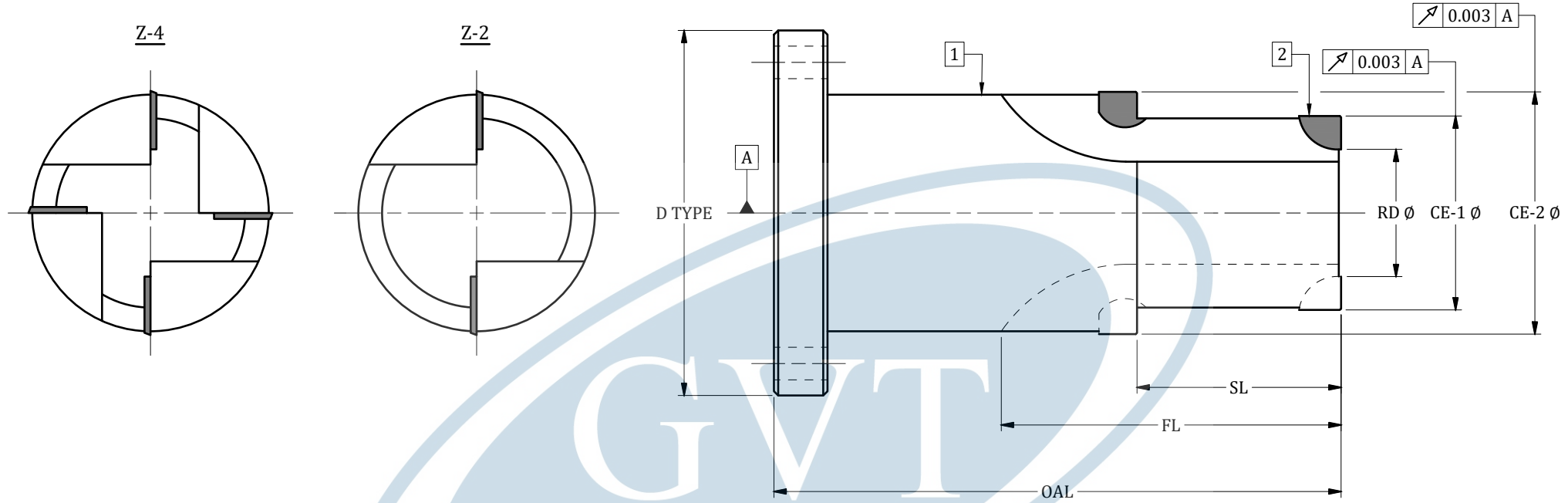

**Tool Specifications:**

- 1. CE-1 Ø - \_\_\_\_\_
- 2. CE-2 Ø (OPTIONAL) - \_\_\_\_\_
- 3. RD Ø - \_\_\_\_\_
- 4. SL - \_\_\_\_\_
- 5. FL - \_\_\_\_\_
- 6. OAL - \_\_\_\_\_
- 7. Z - 2  4
- 8. Thr.Coolant - Yes  No

**Run-out Adjustment Configurations:**

D TYPE : FAST RUN-OUT THRUING

M TYPE : HIGHER RIGIDITY

\* DYNAMICALLY BALANCED

THIS DRAWING BELONGS TO GV TOOL CO.,  
NEITHER THE ORIGINAL NOR REPRODUCTIONS MAY BE  
MADE ACCESSIBLE TO ANY THIRD PARTY WITHOUT CONSENT

2	2 / 4 / 8	PCD			
1	1	Steel			
Part No	Quantity	Description	Specification	Application	Coating
Designed by P.S.K	Checked by S.P	Approved by S.V	Date	Drg. Date	T.A.P
Title: Multi Step PCD Reamer with Flange					All Dimensions are in mm
Part Code:				Revision 0	Sheet 1 / 1
					Customer



**GV TOOL CO.,**  
CHENNAI-600 053.

Work Material	Work Hardness	Machine	Current Vc	Current Feed	Coolant Pressure
---------------	---------------	---------	------------	--------------	------------------